

# Rappan Athuk 3

Level 12: The Slave Pits

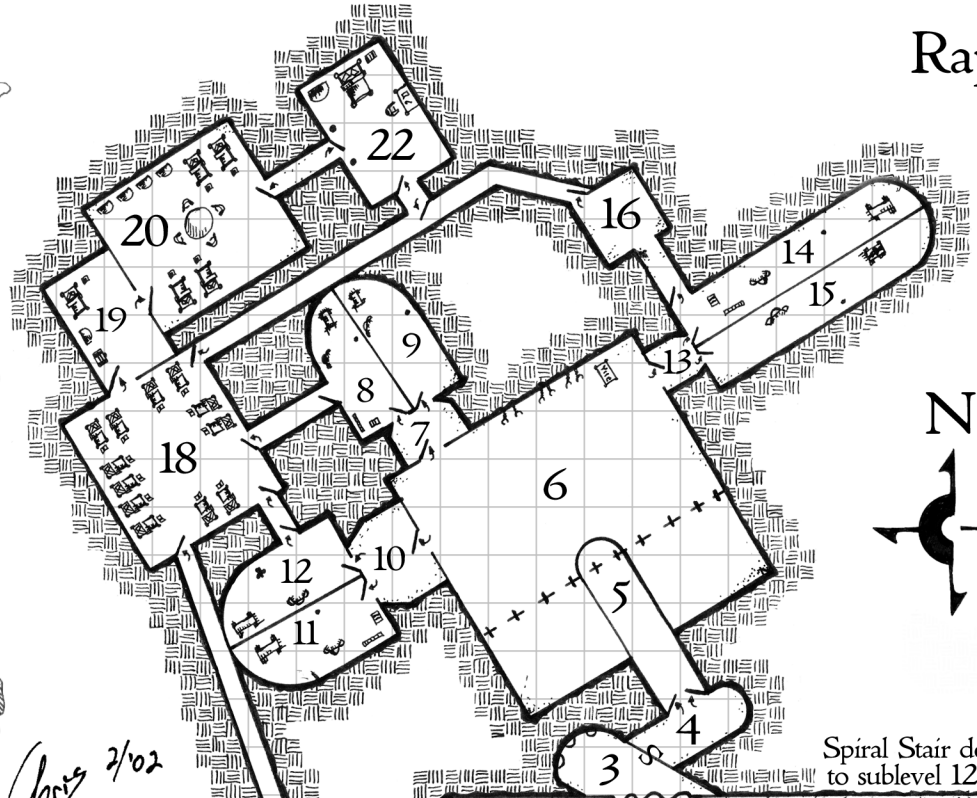

**KEY**

- Secret Door
- Portcullis
- Tar Pit
- Lavish Bed
- Table and Chairs
- Corpse



1 Square equals 10 ft.

*Chris 2/02*

Spiral Stair down to sublevel 12-21.

From Underground

From Level 12A

Ladder to Level 10A

To Underground

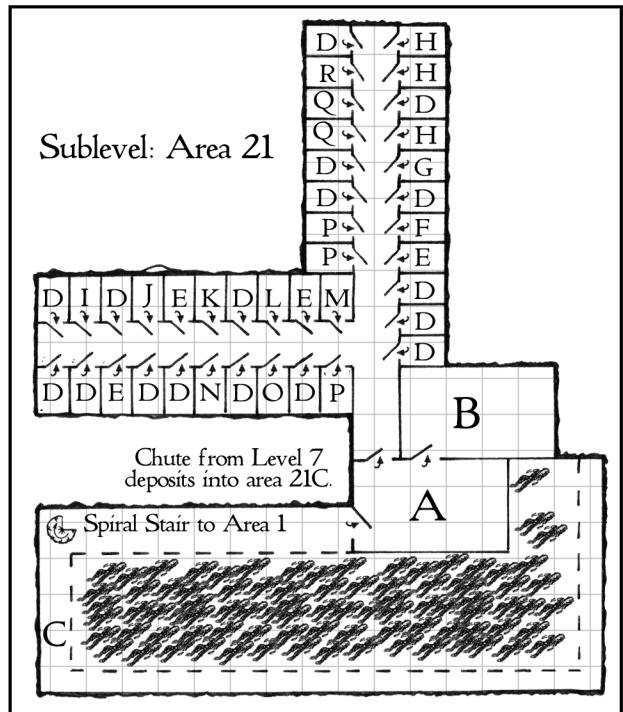

Spiral Stairs to Level 14

